

PARTS PACKING LIST

Evaporator assembly
Drain tube
Plastic air plug
Hardware package



3601 W. Clarendon
Phoenix, Arizona 85019
(602) 233-0090
800-648-4475
www.ackits.com

11040
2003-4
Jeep Wrangler

EVAPORATOR INSTALLATION INSTRUCTIONS

Removal of the heater case assembly:

1. Disconnect the battery. **This is important!** This will prevent air bag deployment.
2. Pry upwards and remove the defroster vent cover to expose the nuts on 4 studs across the top of the dash. Remove the nuts and retain.
3. Remove the two oval head screws securing the plastic cover under the steering column. Unclip the two clip on the top edge of the panel and pivot the panel downwards off the light switch and 3-clips on the bottom. Remove the panel. On some models, there is a metal cover that has 4 screws that must be removed from behind the kick panel.
4. Remove the plastic cover around the steering column (3 phillop screws accessed from the bottom part). Removal of the covers will prevent damage of scratches by the dash assembly. Remove the four (4) nuts (13mm socket) securing the steering column. Let the column drop downwards and rest onto the front seat.
5. Remove the floor console assembly from around the shifter:
Carefully pry the rubber boot assembly upwards around the shifter. Remove the screw under the boot assembly securing the console to the floor. Remove the rubber cup bottom; under it, locate and remove another screw holding the console to the floor. Remove the console assembly disconnecting the Air bag cut off switch wiring from the switch. Vehicles with a full console, remove the two screws inside the rear of the glove box and the two screws mounted at the bottom on the outside of the console.
6. Remove the door light switches. Push them forward through their mounting holes and remove the wiring. (This will prevent them from getting broken when the dash is removed)
7. Remove the glove box assembly. **IMPORTANT! Locate the small yellow plug through the glove box opening, (In the upper left corner) and disconnect. This is the air bag signal wires. The wiring is short and will break if not unplugged before removing the dash.**

8. Disconnect the following items through the glove box opening before the dash is set back from the firewall.
 - a. 6-wire plug black with the red clip. (heater supply wires)
 - b. Multi vacuum line plug
 - c. radio antenna wire
 - d. small fuse box towards the top of the glove box. (two screws) Also the wiring harness plug next to the fuse box.
9. Remove the 3 torx-head bolts along both sides of the dash. Remove the 2 nuts securing the passenger side air bag accessed through the glove box opening. This will allow the dash assembly to be pulled away from the firewall.
10. Remove the heater deflector piece from the bottom of the heater case. (2-screws) This will allow more clearance when removing the heater case from the vehicle.
11. In the engine compartment, crimp off the heater hoses and remove the hoses from the heater core assembly fittings. Use the 5/8" and the 3/4" orange plugs (provided in the hardware package) in the heater fitting to prevent coolant from spilling in the vehicle.
12. Remove the 5 nuts off the stud on the firewall retain the heater case assembly. One is located to the far passenger side behind the battery, two near the heater fittings, and two behind the engine, centered in the vehicle. The lower nut also retains the plastic rain gutter, be sure to remove both nuts from this stud. Also disconnect the vacuum supply line.
13. From inside the vehicle remove the bolt retaining the front edge of the heater assembly. (glove box area) The heater case assembly is now ready for removal. Lift the dash up out of the way and remove the case assembly from the vehicle.

Evaporator coil installation in the heater case. SEE DIAGRAMS pages 4 and 5.

1. On the bench remove the 5 screws around the fresh air plenum. It will be necessary to remove the door actuator to access all the screws. Remove the 14 screws and 2 case clips around the case. Remove the foam pad around the heater fittings. Separate the case.
2. Slide the evaporator coil into position. Be sure to check the operation of the all doors before reinstallation of the case into the vehicle.
3. Drill a hole as shown to route the thermostat cap tube through the case. (See the diagram page 5.)
4. Place the top back on and re-secure.
5. Use prestite tape to seal air leaks around the A/C fittings. With a razor knife slit the OEM foam pad for A/C fitting. Reinstall the foam around the heater fittings, A/C fitting, and the vacuum supply line.
6. Mount the thermostat onto the case assembly on the fresh air plenum using self-tapping screws. Route the wires through the firewall with the evaporator fittings.
7. Check the operation of all mode doors.
8. The case assembly is ready for reinstallation.

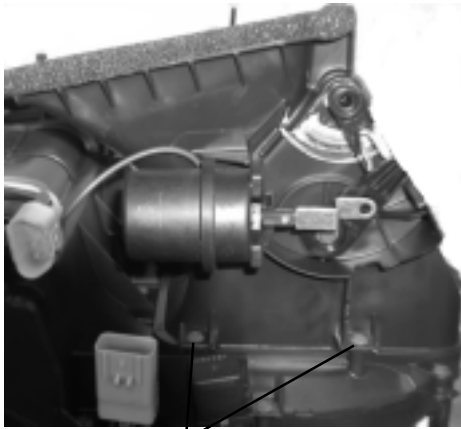

Remove actuator on fresh air plenum in order to access these screws.

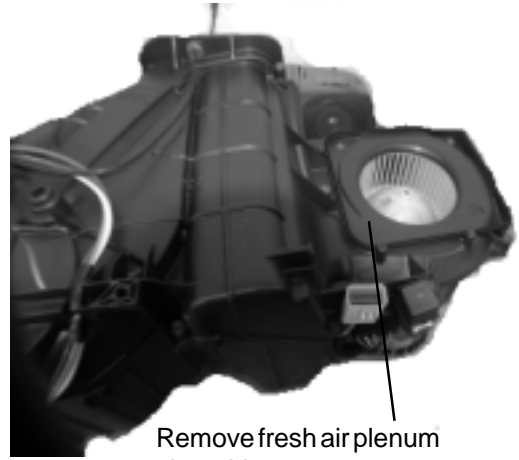

Remove fresh air plenum above blower



Remove the 14 screws holding the case halves together.

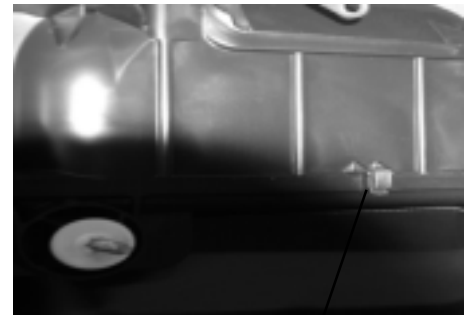

Remove the two case clips.



CAREFULLY remove actuator. Plastic parts break easily.



Remove floor vent duct.



Remove this screw under duct on the bottom of the case. Remove actuator.

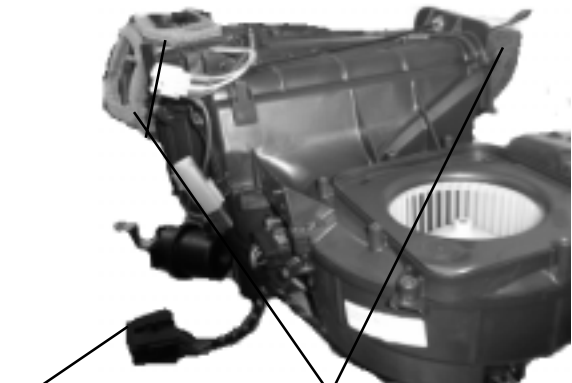

Carefully pull back foam gaskets. They can also be cut if desired. Remove the door motor on the bottom of the case so that proper operation of the door can be checked when case is re-assembled.



Separate case halves.



Carefully insert evaporator coil into the case. Cut a slot in the foam gasket for the tubes. Re-assemble in reverse order.



Use a small screwdriver to align the doors back into place.



Drill a 1/8" hole and insert thermostat capillary tube into coil.

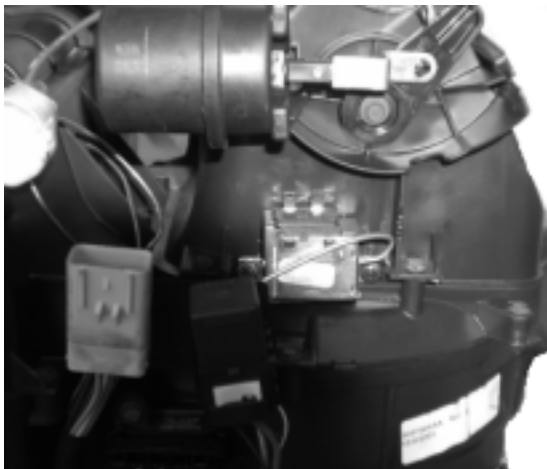

Mount thermostat here after re-assembling the fresh air plenum

Reinstallation of the case assembly into the vehicle:

Be sure the fresh air plenum is re-attached to the case before installation.

1. Hold the dashboard away from the firewall. Place the heater case assembly in the vehicle and secure to the firewall with the 5 nuts on the studs. Replace the plastic rain gutter piece secured by the center stud with the extra nut.
2. Install the bolt which secures the top of the heater case left of the fuse box. Reinstall the small fuse box. Replace the heater deflector on the bottom of the case. (2 screw)
3. Set the dashboard assembly back up on the 4 studs across the windshield.
NOTE: Reconnect the radio antenna into the radio.
4. Reconnect the yellow connector above the defroster plume, single red wire connector, and 6-wire plug connect/ with the red clip, to the heater case assembly.
5. Resecure the dash assembly. (4-nuts across the top of the dash, 3-Torx head bolts along each side of the dash, 2-nuts securing the passenger side air bag located through the glove box opening.)
6. Reattach the door switches on both sides.
7. Resecure the steering column using the four nuts removed. Secure the plastic cover under the steering column with 2 oval head screws.
8. Place the console back and secure. Carefully install the rubber boot around the console.

A/C switch installation.

1. **Removal of the center bezel assembly.** First, remove the ash tray assembly and remove the screw retaining the bezel. On the top edge of the bezel remove the two screws. Pry off the bezel.
2. Remove the knobs from the control head and peel off the heater decal. Replace with the a/c decal provided. Remove the four screws retaining the control head. Unplug and remove the heater mode switch and replace with a/c-heater mode switch provided. Replace the knobs. Check that the mode switch knob turns to all modes on decal. Re-mount the control head.
3. Re-install the bezel and glove box door.

PARTS PACKING LIST

14x20 Narrow MFC Condenser
Dryer / Pressure switch
Hardware Kit
Hose Kit

11040B

2003-4 Wrangler



3601 W. Clarendon
Phoenix, Arizona 85019
(602) 233-0090

CONDENSER INSTALLATION INSTRUCTIONS

NOTE THE PLACEMENT OF THE COMPRESSOR IN THE DIAGRAM. THE FITTINGS POINT UPWARDS.

1. Installation of the condenser is made easier if the engine fan and fan shroud are removed. Dismount the radiator from the front cowling.
2. To install the condenser, the front cross member must be removed and moved to the front of it mounts. Use the new 6mm x 20mm bolts with flatwasher in the upper holes. Reuse the lower bolt. (SEE DIAGRAM)
3. Using the diagram secure the lower sheet metal mounts on the condenser and note the bracket on the drivers side is moved over 1 hole. Install the upper bracket on the condenser and note the bracket on the drivers side is move over 2 hole. (SEE THE DIAGRAM)
4. Install the #6 (5/16") hose with the two 90° fittings to the lower fitting of the condenser.
5. Install the #8 (13/32") hose using the 90° **short drop**, and attach to the upper fitting on the condenser, pointing downwards.
6. Install the condenser using extra nuts on the cross member upper studs. Use the 6mm x 16mm bolts, flats and nuts on the lower holes.
7. Remount the radiator.
8. Attach the dryer inlet side to the 90° #6 hose from the lower connection of the condenser and secure. Mount the dryer as shown.
9. Install the expansion valve with the valve pointing downwards.
10. Install the #6 (5/16") hose with the straight 90° fitting between the expansion valve (90°) and the

dryer outlet. (straight). Secure to the fender with mounting clamps where needed.

11. Install the 90° #10 (1/2") suction hose to the evaporator fitting. Attach the 45° fitting to the compressor. (see the diagram.)

12. Connect the bulb of the expansion valve to the 90° #10 (1/2") suction fitting using the metal snap clip. Use prestite tape around the bulb to insulate.

13. Locate the OEM two-pin connector between the rear of the compressor and the distributor (light green/blue-orange wires). Cut off connector and butt connect to the thermostat wires (green/blue). Ensure that the vacuum line disconnected during disassembly of the evaporator case is re-attached.

14. Locate the OEM two-pin connector on the firewall (blue-white/blue-orange wires). Cut off the connector and butt connect to the pressure switch harness on dryer.

15. Locate the OEM one-pin connector directly behind the compressor (blue/black wire). Cut off the connector and crimp on the round female connector provided in the hardware package. Connect to the compressor clutch wire.

16. Remove the top of the relay/fuse box. Install the relay where in the slot indicated for a/c compressor clutch. If needed, install the ATM 10 amp fuse in the slot designated a/c. This fuse is usually already there. See wiring diagram.

14. Evacuate system for 1 hour then charge system with 24 oz off R134A refrigerant.

2.5L

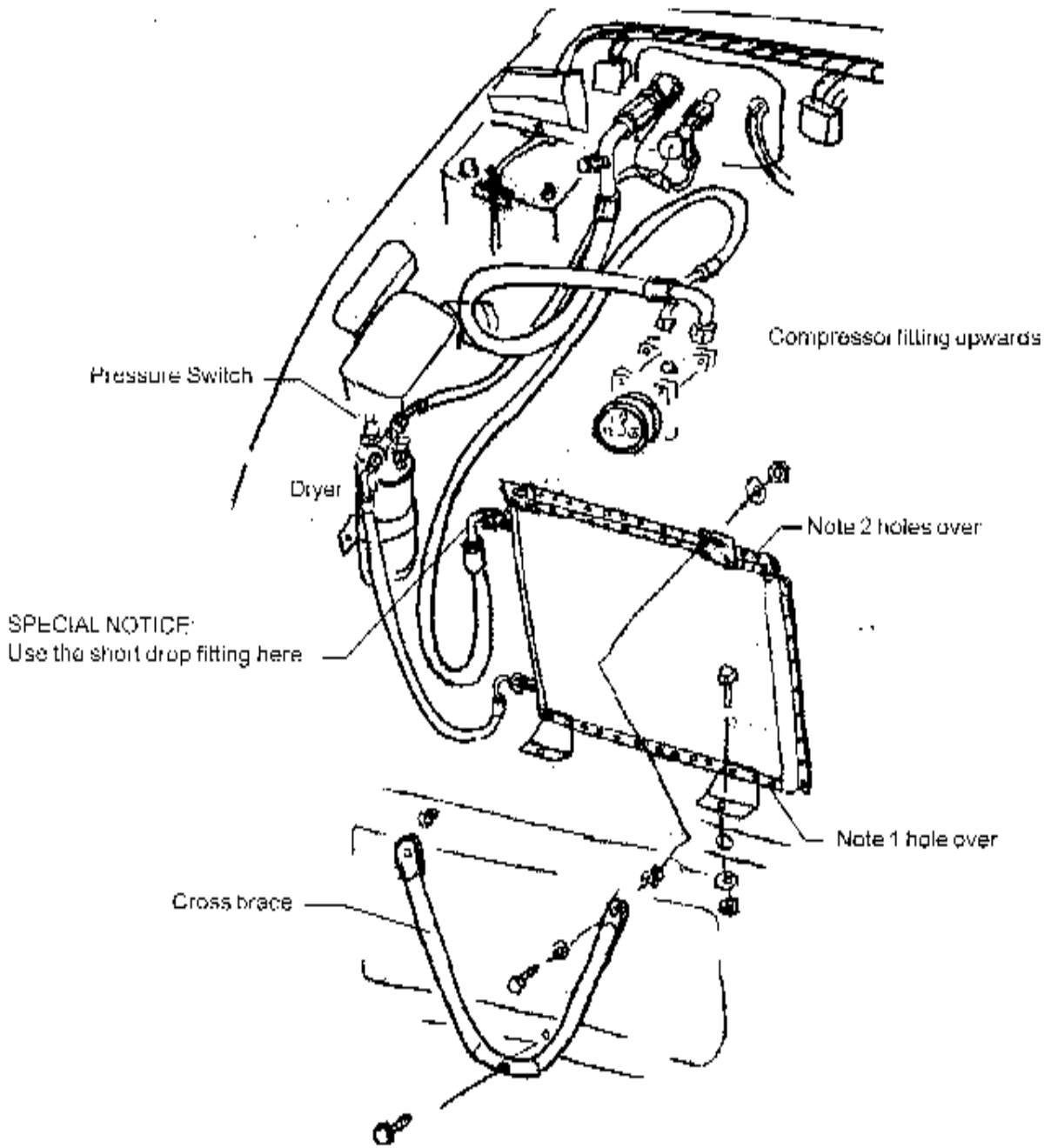

4.0 L

